



Security Engineered Machinery Co., Inc

OPERATIONAL & MAINTENANCE MANUAL

SEM Model ME-P3M

Rev. 2
Revised 07/25/11



As of January 1, 2008

Security Engineered Machinery Co., Inc.

NATIONWIDE SERVICE

Phone Toll Free: 1(800)225-9293

Email: Service@SEMSHRED.com

Fax: (508)366-6814

Website: WWW.SEMSHRED.COM

INDEX

OVERVIEW-----	2-4
SETUP-----	5-6
PRECAUTIONS-----	7
INSTRUCTIONS ON USE-----	8-11
LATCH MECHANISM-----	12
HANDLING ERASED HDDs-----	13
MAINTENANCE/ATTACHMENT-----	14
PROCEDURES FOR MOUNTING DEVICES-----	15-25

For NATIONWIDE SERVICE Call 1(800)225-9293

Thank you for purchasing the ME-P3M. When used correctly, the ME-P3M provides a thorough means to thorough erase sensitive data from magnetic storage products and media, such as Hard Disk Drives and Magnetic Tapes. Please take the time to read this manual before attempting to use the ME-P3M unit for the first time. Keep this manual in a safe place where it will be readily accessible for you to use as an operating reference.



WARNING: Improper use of the ME-P3M can result in serious harm or injury!

People with pacemakers or other devices that are sensitive to magnetic fields should avoid using the ME-P3M.

Read this Manual Completely for other safety warnings.

The manufacturer will not be responsible for any injury or malfunctions resulting from the misuse of this product, other than as set forth in this manual.

For NATIONWIDE SERVICE Call 1(800)225-9293

Overview of the ME-P3M

The ME-P3M employs a hand crank and drive mechanism to cycles the product/media to be erased through a high-intensity magnetic field. Note that the ME-P3M will not only erase the data stored on the HDD but will also render the HDD inoperable.



CAUTION: Improper use of the ME-P3M can result in serious harm or injury! The manufacturer will not be responsible for any injury or malfunctions resulting from the misuse of this product, other than as set forth in this manual.

HDD's that have been erased by ME-P3M cannot be reused or repaired by conventional means. Pre-formatted tape media (LTO and some 3480/3490 cartridges) will also be unusable after being erased in this unit.

The, ME-P3M provides a quick and reliable means to erase data on the following Hard Disk Drives (HDDs):

- 3.5-inch Type "Half-Height" (1" height) HDDs
- 2.5-inch Type HDDs
- 1.8-inch Type HDD & PC-Card HDDs
- Rev Disk

In addition, the ME-P3M can be used to erase the following types of Tape media:

- 3480/3490 Tape Cartridges
- DLT Tapes
- LTO Tapes
- 1/4" Type QIC Tape
- VHS Tape

For NATIONWIDE SERVICE Call 1(800)225-9293

During the erase cycle the ME-P3M manually moves the device loaded in the device tray into the high-strength magnetic field created by the internal magnet assembly, and then back out to the device loading/unloading position. The magnetic field in the ME-P3M is well contained, and operation of the unit poses no risk to credit cards or other magnetically encoded materials, however, *people with pacemakers or other devices that are sensitive to magnetic fields should avoid using the ME-P3M.*

For NATIONWIDE SERVICE Call 1(800)225-9293

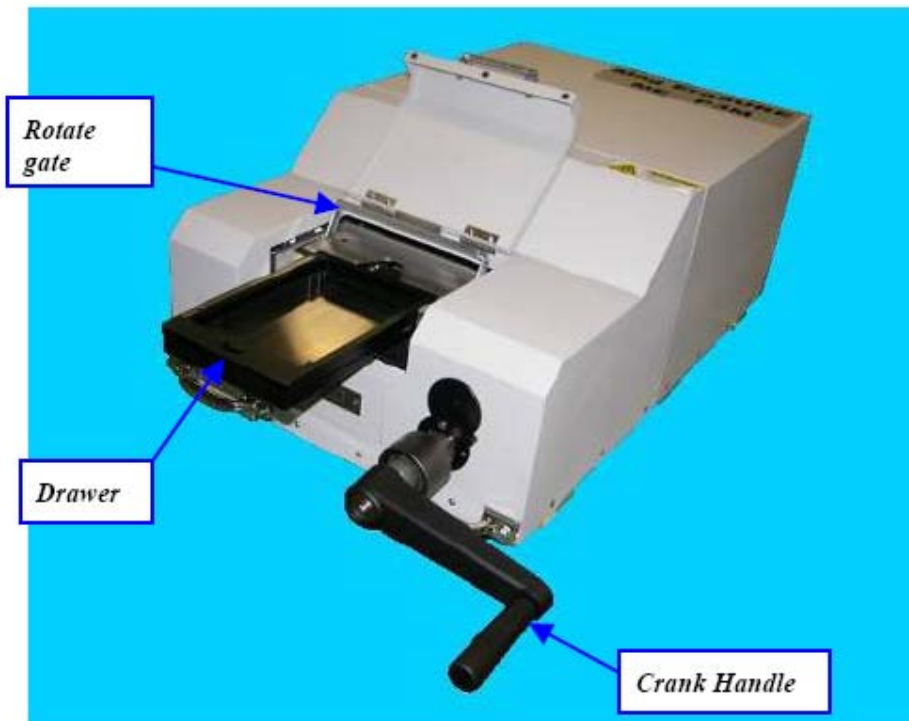
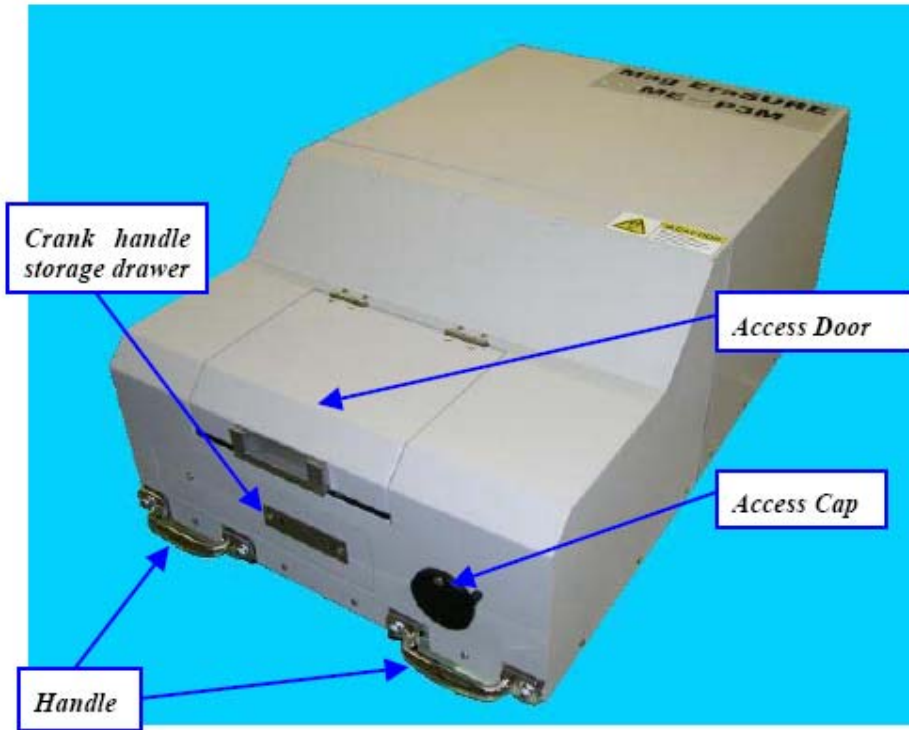

FIGURE 1: The ME-P3M

For NATIONWIDE SERVICE Call 1(800)225-9293

2 ME-P3M OPERATION

2-1 Setting Up the ME-P3M



CAUTION: The, ME-P3M unit is very heavy (approximately 97kg). At least four persons are needed to install or transport the unit. Also, to avoid the possibility of damage, do not grasp the access door when transporting the unit.

Place the ME-P3M on a level surface in a secure location where it will not be subjected to vibration or impact. Avoid using or storing the unit in the following:

- (1) Direct sunlight or other high-temperature locations
- (2) Extremely cold or humid locations, or locations where it could come into direct contact with water or other liquids
- (3) Locations where there is a significant amount of dust, dirt or soot.
- (4) Locations where metal filings or metal particles are present. Metal particles can stick to the unit and are difficult to remove, and will eventually cause the unit to fail.

NOTE: Moving the unit from a cold outdoor environment into a heated room can result in the formation of condensation inside the chassis. In this event, allow the unit to sit and adjust to the new indoor temperature for at least an hour before using it.

2-2 Precautions

When using the ME-P3M, always observe these important safety precautions:

- (1) Do not use ME-P3M for any purpose other than erasing magnetic recorded data from an HDD or a Tape. Do not attempt to erase any devices not listed on page 1 of this manual.
- (2) The strength of the residual magnetic field outside the ME-P3M is very low and poses no direct health risk; however *people with pacemakers or other devices that are sensitive to magnetic fields should not use this product.*
- (3) Do not, place coffee, other beverages or containers of liquid anywhere near the unit. The, ME-P3M unit could malfunction or cause a serious injury if liquid gets into the chassis.
- (4) Do not place objects on the cover or the access door of the ME-P3M unit.
- (5) Store the attachments carefully when they are not in use.
- (6) Do not operate the ME-P3M if it is damaged or defective. If the ME-P3M becomes defective, return it to the place of purchase for repairs.
- (7) Please pay careful attention to the attachment and the operation of crank handle in order to avoid injury.

2-3 Using the ME-P3M

- (1) Pull out the Crank handle storage drawer and remove the Crank handle.



- (2) Close the Crank handle drawer.

- (3) Slide the Access cap upward and insert the Crank handle into shaft.

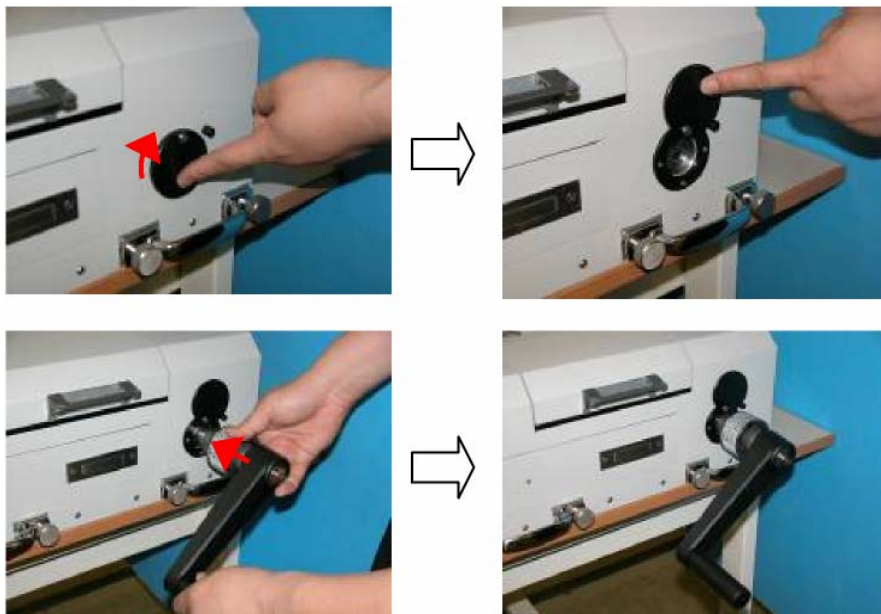

For NATIONWIDE SERVICE Call 1(800)225-9293

- (4) Lift the Access door up.

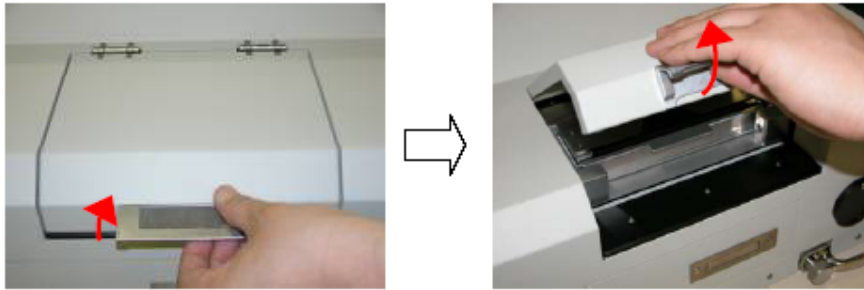

- (5) Check that display indicator shown green in color.

If the display color is "Red", the drawer is locked and cannot be pull out- Go to step number 10.



- (6) Lift the rotate gate.
Then pull out drawer.

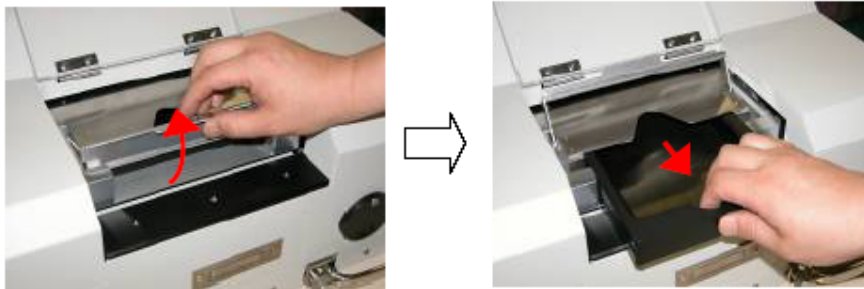

For NATIONWIDE SERVICE Call 1(800)225-9293

- (7) **Install the appropriate Attachment and then insert the device to be erased. Please follow the instructions carefully-using the wrong Attachment, or failing to install the device correctly, can damage the ME-P3M unit.**

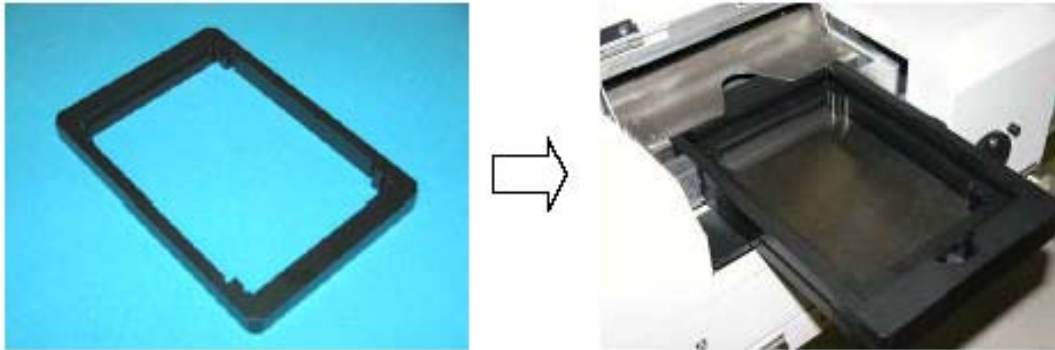

- (8) Return the Drawer then lower the rotate gate.

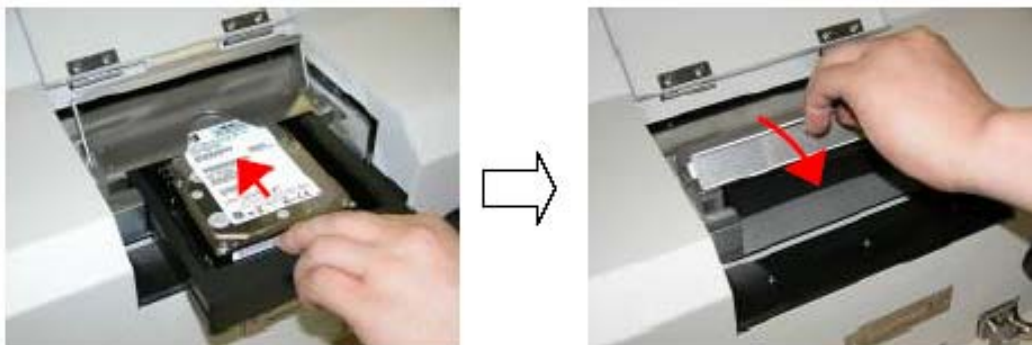

- (9) Close the access door.

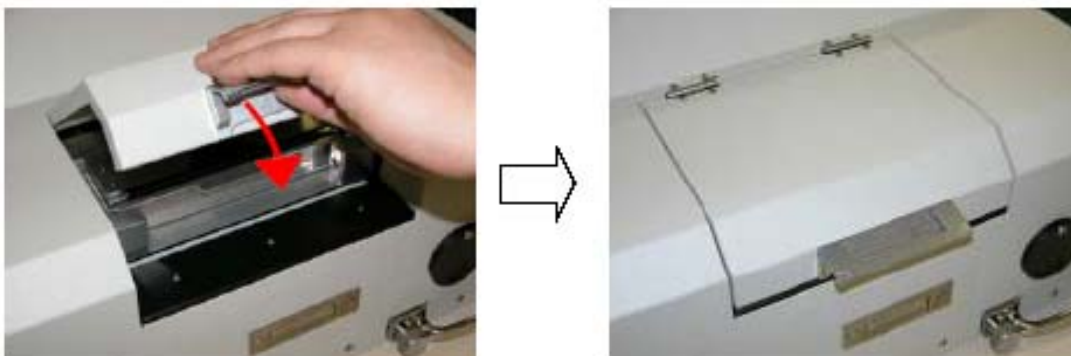

For NATIONWIDE SERVICE Call 1(800)225-9293

- (10) Rotate crank clockwise until contact with stopper. At this time, crank spin free.



- (11) Rotate crank counter clockwise to contact with stopper and at stopper crank spin free again.



- (12) Open the Access door. Operator will see “Green” color in the display hole, and can pull out drawer and remove HDD.
- (13) Repeat steps 7 – 12 for each device to be erased.

2-4 Additional Statement

NOTE: In this degausser erasure of LTO4 & LTO5 tape media storage devices requires an additional step for secure erasure; after the first erasure pass, remove the tape cartridge, rotate the cartridge 90 degrees, replace it in the tray, and erase a second time.

For NATIONWIDE SERVICE Call 1(800)225-9293

2-5 Latch Mechanism

1. Basic Motion

(1) Original Position

Open Access Door to pull out drawer.

(2) Drawer locked position

When crank rotates clockwise by quarter of a round, the drawer will forward by 1 cm, and the slide latch will move to lock position and lock drawer.

(3) Normal Operation

When the drawer moves forward, the End-Block moves the Slide Latch to unlock position and unlock drawer.

Once the drawer moves back to home position and display indicator shows “Green,” the operator then could pull out the drawer and remove HDD.

Repeat the same operation.

(4) Abnormal operation

Once HDD the drawer has move forward over 1 cm, the slide latch will lock up.

If operator tries to rewind the drawer, the slide latch mechanism will lock into position, and the display hole will show “Red,” drawer is locked and cannot be moved.

Operator has to execute normal operation, cranking the handle to move the drawer forward all the way and cranking the handle back out. Only when display indicator shows “Green” that the drawer could be pulled out and HDD could be removed

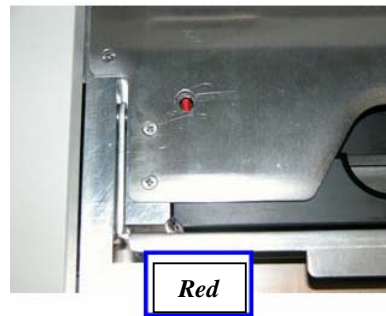

2-6 Handling Erased HDD's

It is recommended that a label be attached to the erased HDD to indicate that the device has been erased by the ME-P3M unit, to prevent others from inadvertently trying to use the device:



FIGURE 2

After being erased by the ME-P3M, HDDs and pre-formatted tape media (LTO and some 3480/3490 cartridges) cannot be reused or repaired. Please dispose of the HDD in accordance with local environmental standards

For NATION WIDE SERVICE Call 1(800)225-9293

2-7 Maintenance

1. Do not remove any covers or plates, or attempt to disassemble or modify this product in any way. There are no user-serviceable parts in the ME-P3M unit and there is a high risk of personal injury if the internal components are handled improperly. **Removing the cover or disassembling this product will void your warranty!**
2. The ME-P3M contains strong magnets. Take appropriate precautions when disposing of the unit.



2-8 Precaution for Correct Use

(1) Attachment

Included attachment must be use when operating device – operating without attachment might cause damage to the unit, and will void the Manufacturer’s Warranty.

Attachment

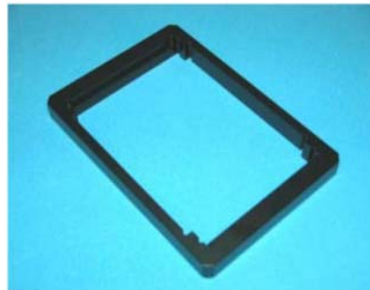

FIGURE 3: Attachment

(2) Erasing HDD

If some bracket attached to HDD, remove the bracket then do the operation.



For NATIONWIDE SERVICE Call 1(800)225-9293

3 PROCEDURES FOR MOUNTING DEVICES

3-1 3.5-inch Type Half-Height (1-inch height) HDD

- (1) Open the Access cap and attach the crank handle into the shaft.
- (2) Open the access door.
- (3) Raise the rotate gate and pull out the drawer.
- (4) Set the attachment in the drawer.
- (5) Set the 3.5" Type HDD inside the attachment.

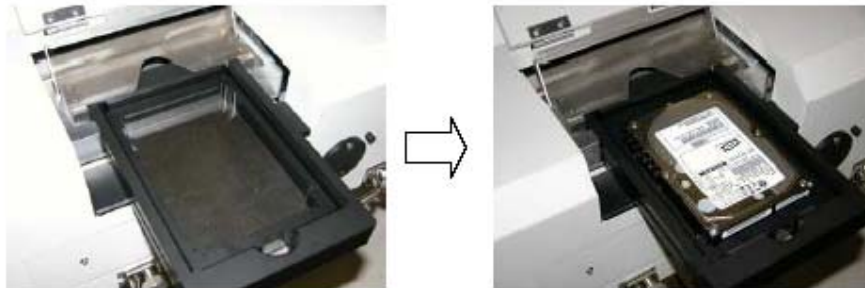

- (6) Slide the drawer into unit then lower the rotate gate.
- (7) Close the access door.
- (8) Rotate crank forward clockwise until contact with back stopper. At this time the crank will spin free.
- (9) Rotate crank counter clockwise to back out until contact with front stopper and at stopper crank will spin free again.
- (10) Open the access door to remove the 3.5" type HDD.

For NATIONWIDE SERVICE Call 1(800)225-9293

3-2 2.5-inch Type HDD (12.5 mm height / 9.5 mm height)

- (1) Open the Access cap and attached the crank handle into the shaft.
- (2) Open the access door.
- (3) Raise the rotate gate and pull out the drawer.
- (4) Set the attachment in the drawer.
- (5) Set the 2.5" type HDD inside the attachment

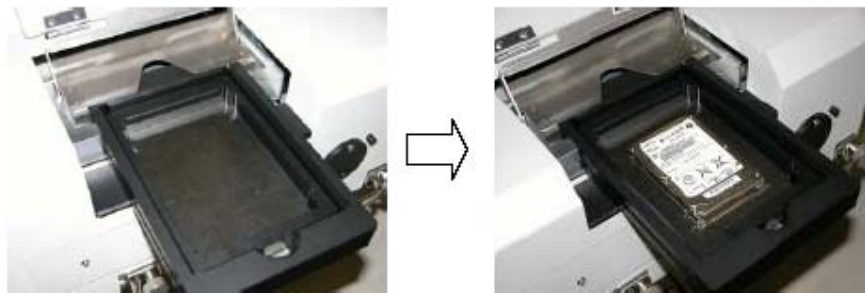

- (6) Return the drawer then lower the rotate gate.
- (7) Close the access door.
- (8) Rotate crank forward clockwise until contact with back stopper. At this time the crank will spin free.
- (9) Rotate crank counter clockwise to back out until contact with front stopper and at stopper crank spin free again.
- (10) Open the access door to remove the 2.5" type HDD.

For NATIONWIDE SERVICE Call 1(800)225-9293

3-3 1.8-inch Type HDD

- (1) Open the Access cap and attached the crank handle into the shaft.
- (2) Open the access door.
- (3) Raise the rotate gate and pull out the drawer.
- (4) Set the attachment in the drawer.
- (5) Set the 1.8" type HDD inside the attachment.

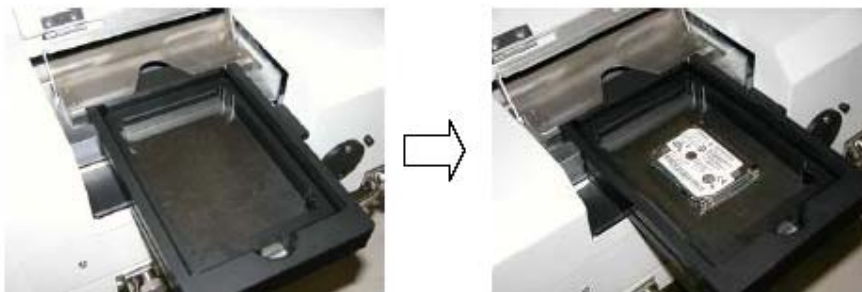

- (6) Return the drawer then lower the rotate gate.
- (7) Close the access door.
- (8) Rotate crank forward clockwise until contact with back stopper. At this time the crank will spin free.
- (9) Rotate crank counter clockwise to back out until contact with front stopper and at stopper crank will spin free again.
- (10) Open the access door to remove the 1.8" type HDD.

For NATIONWIDE SERVICE Call 1(800)225-9293

3-4 1.8-inch Type HDD (PC-Card Mounted)

- (1) Open the Access cap and attached the crank handle into the shaft.
- (2) Open the access door.
- (3) Raise the rotate gate and pull out the drawer.
- (4) Set the attachment in the drawer.
- (5) Set the 1.8" type HDD inside the attachment.

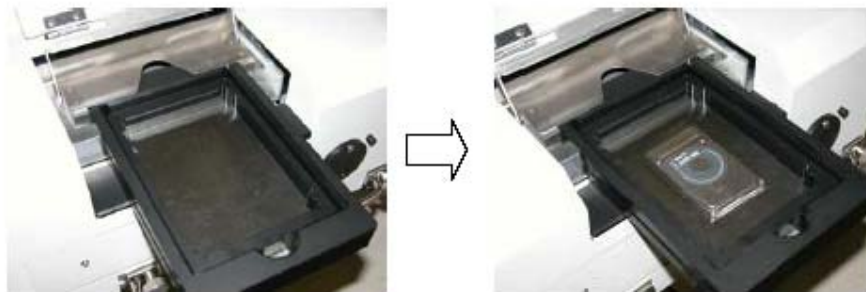

- (6) Return the drawer then lower the rotate gate.
- (7) Close the access door.
- (8) Rotate crank forward clockwise until contact with back stopper. At this time the crank will spin free.
- (9) Rotate crank counter clockwise to back out until contact with front stopper and at stopper crank will spin free again.
- (10) Open the access door to remove the 1.8" type HDD.

For NATIONWIDE SERVICE Call 1(800)225-9293

3-5 Rev Disk

- (1) Open the Access cap and attached the crank handle into the shaft.
- (2) Open the access door.
- (3) Raise the rotate gate and pull out the drawer.
- (4) Set the attachment in the drawer.
- (5) Set the Rev Disk inside the attachment.

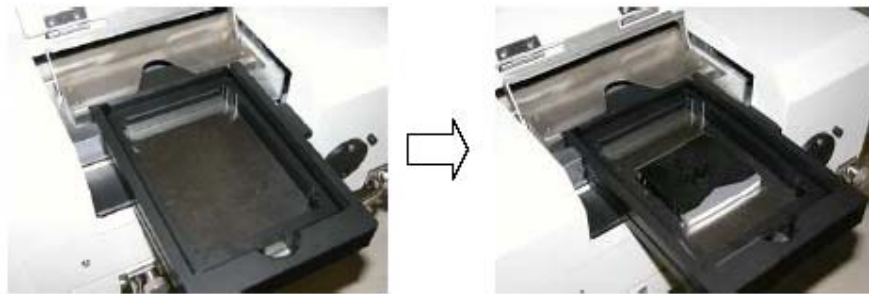

- (6) Return the drawer then lower the rotate gate.
- (7) Close the access door.
- (8) Rotate crank forward clockwise until contact with back stopper. At this time the crank will spin free.
- (9) Rotate crank counter clockwise to back out until contact with front stopper and at stopper crank will spin free again.
- (10) Open the access door to remove the Rev Disk.

For NATIONWIDE SERVICE Call 1(800)225-9293

3-6 3480 / 3490 1/2-inch Tape Cartridge

- (1) Open the Access cap and attached the crank handle into the shaft.
- (2) Open the access door.
- (3) Raise the rotate gate and pull out the drawer.
- (4) Set the attachment in the drawer.
- (5) Set the 3480/3490 Tape Cartridge inside the attachment.

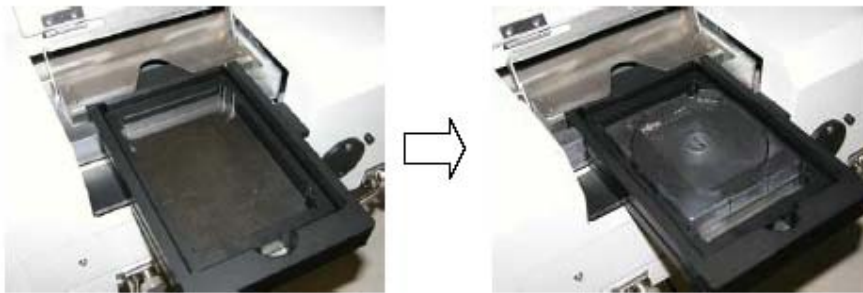

- (6) Return the drawer then lower the rotate gate.
- (7) Close the access door.
- (8) Rotate crank forward clockwise until contact with back stopper. At this time the crank will spin free.
- (9) Rotate crank counter clockwise to back out until contact with front stopper and at stopper crank will spin free again.
- (10) Open the access door to remove the 3480/3490 Tape Cartridge.

For NATIONWIDE SERVICE Call 1(800)225-9293

3-7 DLT Tape

- (1) Open the Access cap and attached the crank handle into the shaft
- (2) Open the access door.
- (3) Raise the rotate gate and pull out the drawer.
- (4) Set the attachment in the drawer.
- (5) Set the DLT Tape inside the attachment.

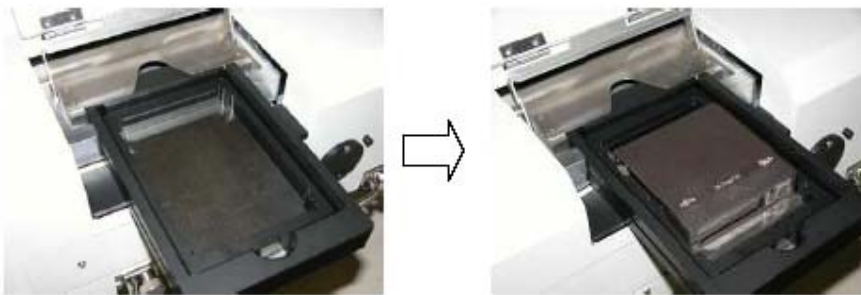

- (6) Return the drawer then lower the rotate gate.
- (7) Close the access door.
- (8) Rotate crank forward clockwise until contact with back stopper. At this time the crank will spin free.
- (9) Rotate crank counter clockwise to back out until contact with front stopper and at stopper crank will spin free again.
- (10) Open the access door to remove the DLT Tape.

For NATIONWIDE SERVICE Call 1(800)225-9293

3-8 LTO Tape

- (1) Open the Access cap and attached the crank handle into the shaft
- (2) Open the access door.
- (3) Raise the rotate gate and pull out the drawer.
- (4) Set the attachment in the drawer.
- (5) Set the LTO Tape inside the attachment.

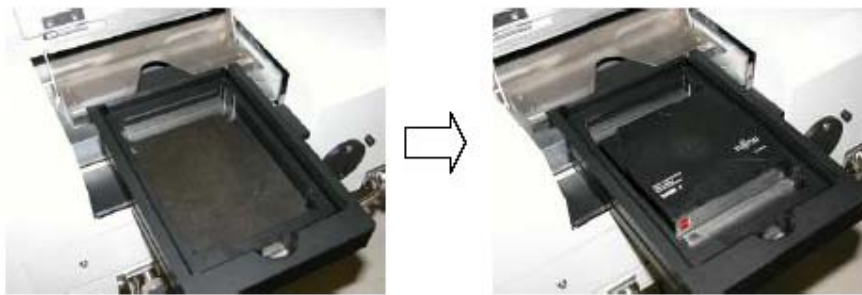

- (6) Return the drawer then lower the rotate gate.
- (7) Close the access door.
- (8) Rotate crank forward clockwise until contact with back stopper. At this time the crank will spin free.
- (9) Rotate crank counter clockwise to back out until contact with front stopper and at stopper crank will spin free again.
- (10) Open the access door to remove the LTO Tape.

For NATIONWIDE SERVICE Call 1(800)225-9293

3-9 1/4-inch QIC Tape

- (1) Open the Access cap and attached the crank handle into the shaft.
- (2) Open the access door.
- (3) Raise the rotate gate and pull out the drawer.
- (4) Set the attachment in the drawer.
- (5) Set the 1/4-inch QIC Tape inside the attachment.

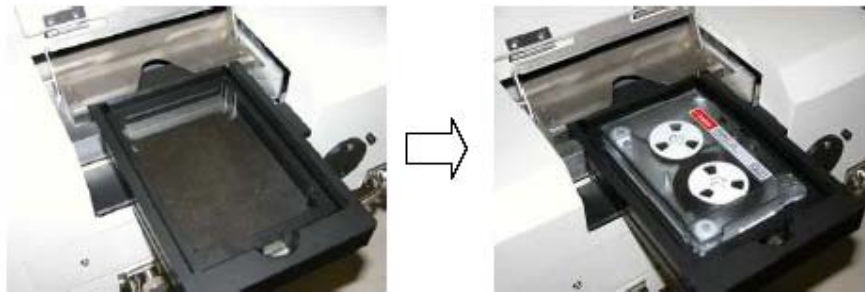

- (6) Return the drawer then lower the rotate gate.
- (7) Close the access door.
- (8) Rotate crank forward clockwise until contact with back stopper. At this time the crank will spin free.
- (9) Rotate crank counter clockwise to back out until contact with front stopper and at stopper crank will spin free again.
- (10) Open the access door to remove the 1/4-inch QIC Tape.

For NATIONWIDE SERVICE Call 1(800)225-9293

3-10 VHS Tape

- (1) Open the Access cap and attached the crank handle into the shaft.
- (2) Open the access door.
- (3) Raise the rotate gate and pull out the drawer.
- (4) Set the VHS Tape inside.

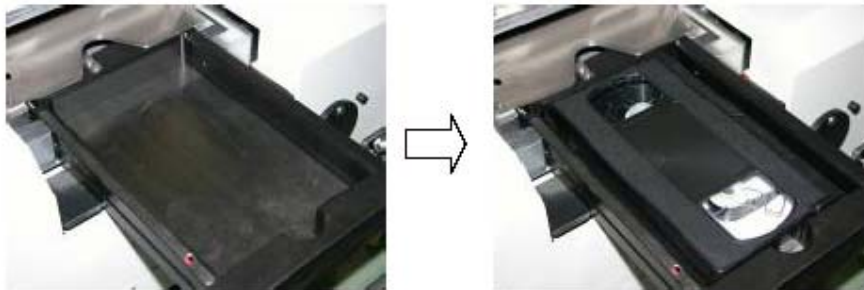

- (5) Return the drawer then lower the rotate gate.
- (6) Close the access door.
- (7) Rotate crank forward clockwise until contact with back stopper. At this time the crank will spin free.
- (8) Rotate crank counter clockwise to back out until contact with front stopper and at stopper crank will spin free again.
- (9) Open the access door to remove the VHS Tape.

For NATIONWIDE SERVICE Call 1(800)225-9293

4 Specifications

Outside dimension: 446mm(W) X 715mm(D) X 285mm(H)

Weight Approx. 97Kg

Operating Temperature Range: -40 to 65°C

Operating humidity Range: 5 to 95% RH

These specifications may vary and may change without prior notice.

5 Supplied Accesssories

(1) Attachment

(2) "ERASED" label(3000 pcs)